

1

2

3

4

5

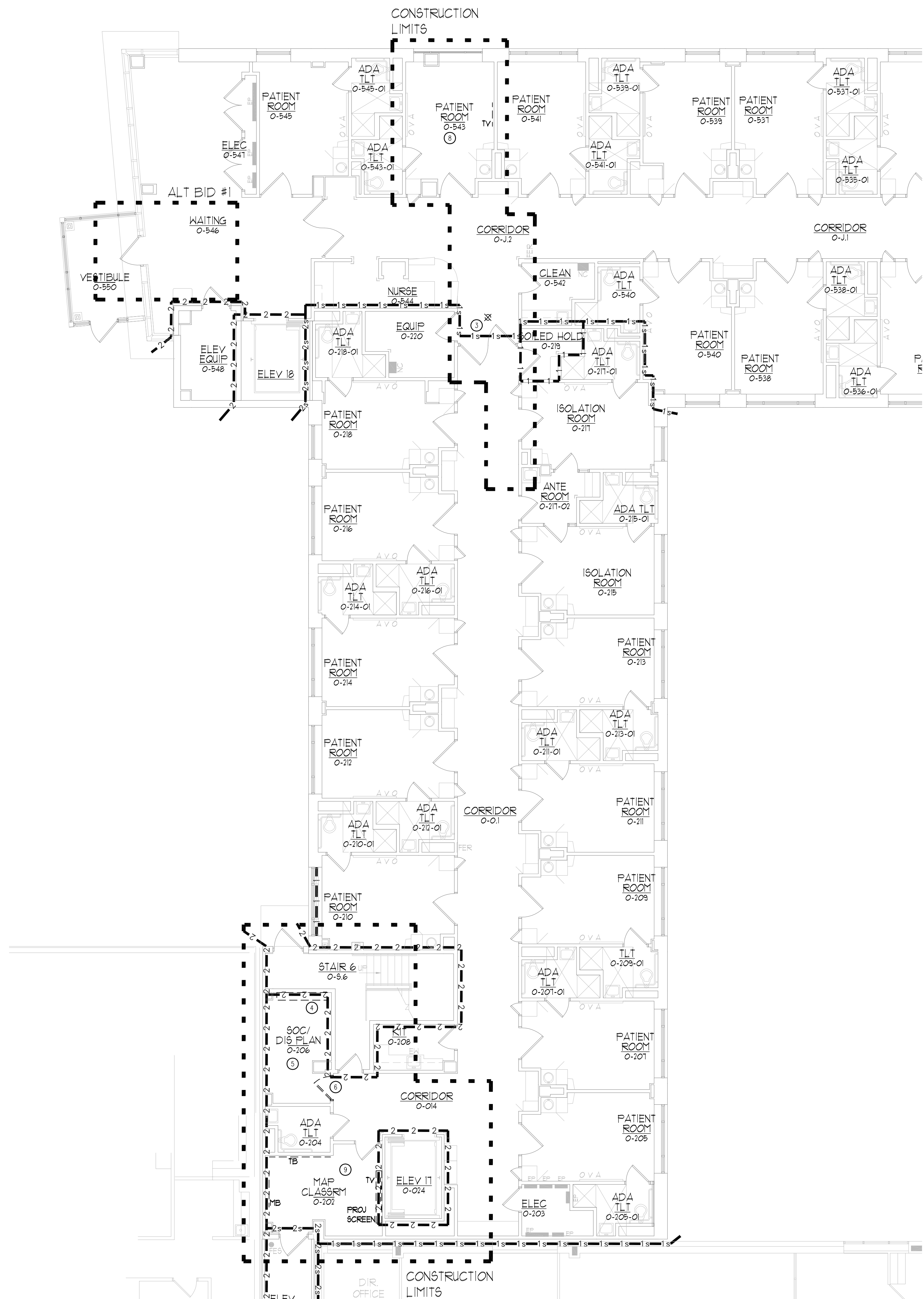

- DEMOLITION PLAN - SYMBOLS LEGEND**
- EXISTING ITEM TO REMAIN
 - EXISTING ITEM TO BE REMOVED
 - DEMOLITION PLAN NOTE
 - CONSTRUCTION LIMITS

- DEMOLITION PLAN - GENERAL NOTES**
- A. VERIFY ALL DIMENSIONS AND CONDITIONS AT JOB SITE. PORTIONS OF EXISTING CONSTRUCTION MAY HAVE BEEN REMOVED BY OWNER.
 - B. MAINTAIN CONTINUOUS UTILITY SERVICE TO ALL SPACES IN THE BUILDING NOT AFFECTED BY THIS WORK. COORDINATE WITH OWNER ANY DISRUPTION IN SERVICES REQUIRED TO PERFORM WORK OR TO MODIFY EXISTING PIPING, DUCTWORK OR ANY ASSOCIATED EQUIPMENT.
 - C. CONSTRUCT A DUST-PROOF PARTITION TO SEPARATE AREAS OF CONSTRUCTION FROM ADJACENT OCCUPIED AREAS OUTSIDE SCOPE OF CONSTRUCTION.

- DEMOLITION PLAN NOTES**
- 1 REMOVE & SALVAGE EXTG HANDREADERS, RELOCATE ONE HANDREADER PER SHEET 201, TURN THE REMAINING HANDREADER OVER TO THE OWNER
 - 2 REMOVE & SALVAGE EXTG LOCKNETICS MAGNETS, DOOR OPERATOR AND POWER SUPPLY, RELOCATE TO DOOR O-01 PER SHEET 201. REMOVE EXTG AUTOMATIC DOOR DECALS & DELAYED EGRESS SIGNAGE. RELOCATE (1) DELAYED EGRESS SIGN TO THE EAST FACE OF DOOR O-5.6.1
 - 3 REMOVE EXTG WALL MAGNETS, CLOSERS & EXIT SIGN FROM WEST SIDE OF EXTG DOORS EXTG SMOKE DETECTORS TO REMAIN
 - 4 REMOVE EXTG SHELF & BRACKETS
 - 5 REMOVE EXTG CEILING TILE, CEILING GRID IS TO REMAIN IN PLACE. REMOVE EXTG FLOORING & WALL BASE, FURNITURE WIRING, WALL BRACKETS & COAT HOOKS. EXTG SYSTEM FURNITURE AND SHELVING BINS WILL BE REMOVED BY THE OWNER.
 - 6 REMOVE EXTG DOOR & FRAME, SALVAGE EXTG BUTT HINGES FOR REUSE
 - 7 EXTG TOYS, PICTURE, TOY SHELF & SIGNAGE TO BE REMOVED BY OWNER & RELOCATED TO NEW PLAY ROOM
 - 8 EXTG TV, SHARPS CONTAINER, RED DISPOSAL, GLOVE BOX & TELEMETRY MONITOR TO BE REMOVED BY OWNER
 - 9 REMOVE & SALVAGE EXTG TACKBOARD, MARKERBOARD CABINET & PROJECTION SCREEN, TURN OVER TO OWNER. EXTG CABINET, AV SHELF, WALL PHONE & TV TO BE REMOVED BY OWNER
 - 10 EXTG DOORS & SECURITY HARDWARE TO REMAIN

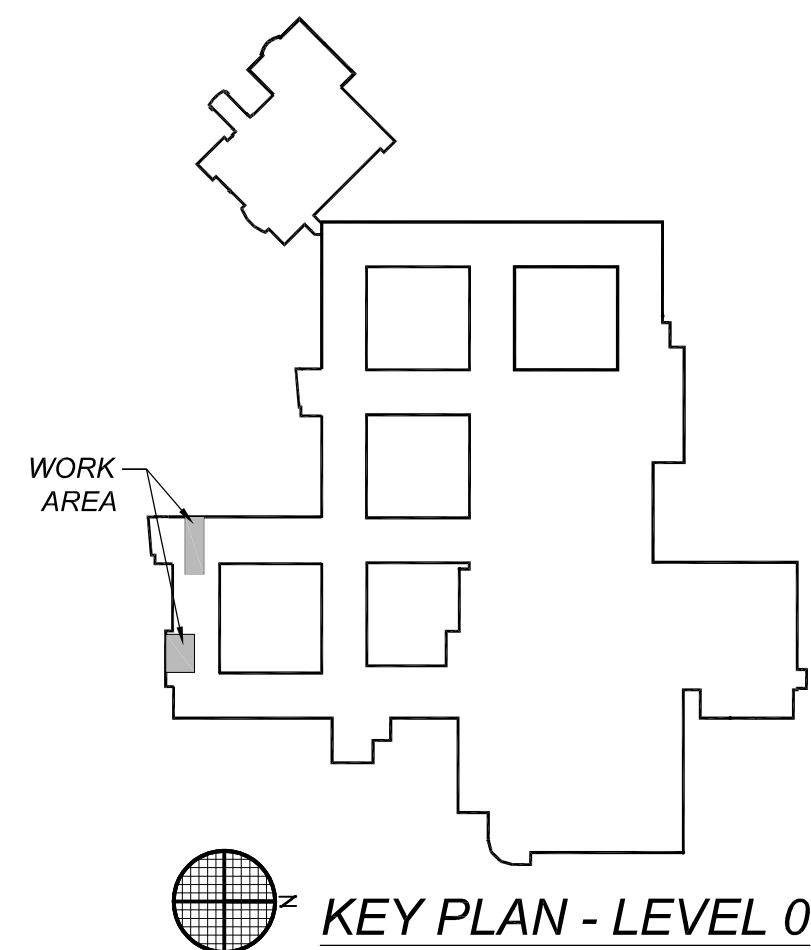

KEY PLAN - LEVEL 0

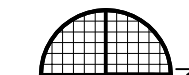

PARTIAL LEVEL 0 DEMOLITION PLAN

© 2011 Plunkett Raysich Architects, LLP

Drawn By:
RLM

Date:
3/11/11

Job No.:
11022

Sheet No.:
101

ASPIRUS WAUSAU HOSPITAL
PEDS RELOCATION
333 PINE RIDGE BLVD, WAUSAU, WI 54401

11000 West Park Place • Milwaukee WI 53224 • Tel 414 359-3080 • Fax 414 359-3070
Plunkett Raysich Architects
Intelligent Designs
www.prarch.com

Inspired Results